

SGA INITIATIVES 2025-2026

**PRESENTED BY RUBY KNIGHT,
DIRECTOR OF ACADEMIC AFFAIRS**

OUTLINE

- Overview
- Academic Services
- Other Pertinent Initiatives
- Surveys
- Focus Groups

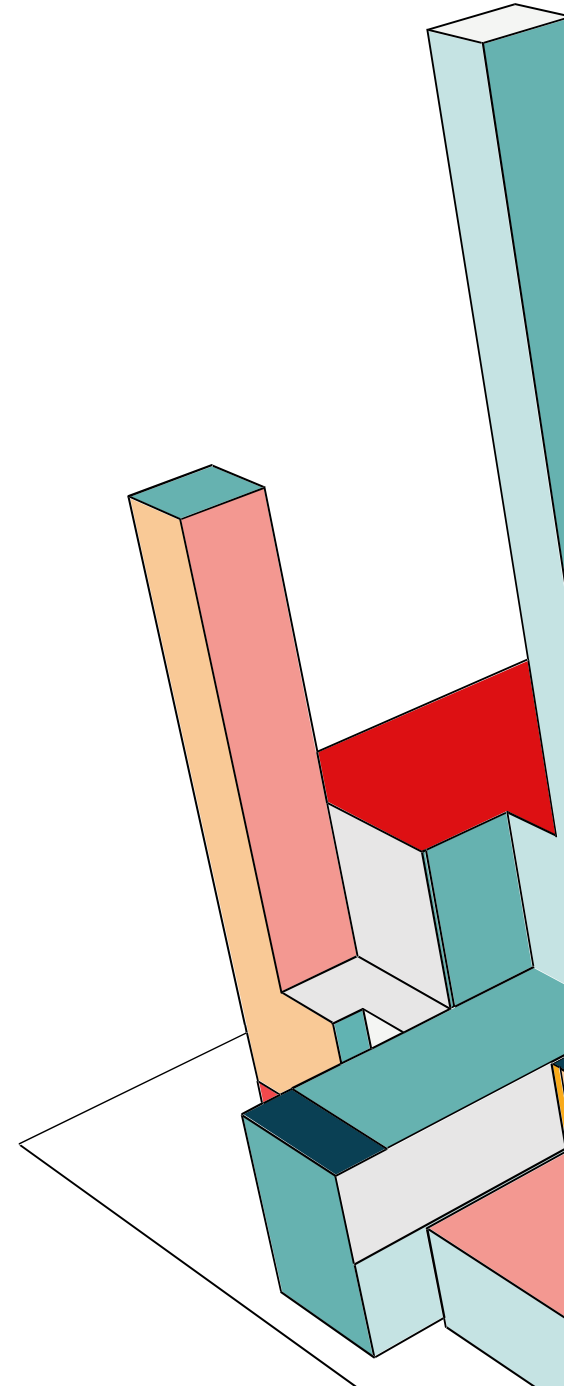

PLATFORM OVERVIEW

FINANCIAL SERVICES
ACADEMIC SERVICES
COMMUNITY SERVICES





ACADEMIC SERVICES

SGA recognizes the need for consistent, student-centered practices, which can be strengthened through stronger relationships between the Student and Faculty Senates.

- Expanding open educational resources and textbook accessibility.
- Advocating for fair, consistent policies on AI usage, inclement weather decisions, academic integrity, and learning management systems.
- Enhancing GEP 101 and UHC 110 to better support student success and opportunity.

WORKING TOWARDS THESE GOALS, WE HAVE:

- Released an Artificial Intelligence Survey, which is nearing 500 responses, to accurately gauge students opinions on AI use in the classroom.
- Discussed GEP 101 and UHC 110 conditions with Dr. Tracy Glaessgen (Associate Director of CAST), Dr. Kelly Wood (Associate Provost for Student Success), and Scott Handley (Associate Director of the Honors College).
- Discussed Open Educational Resources and other affordability initiatives with Sarah Gott (Bookstore Course Materials Manager), Tracy Stout (Instructional Services Librarian), and David Richards (Dean of the Library).

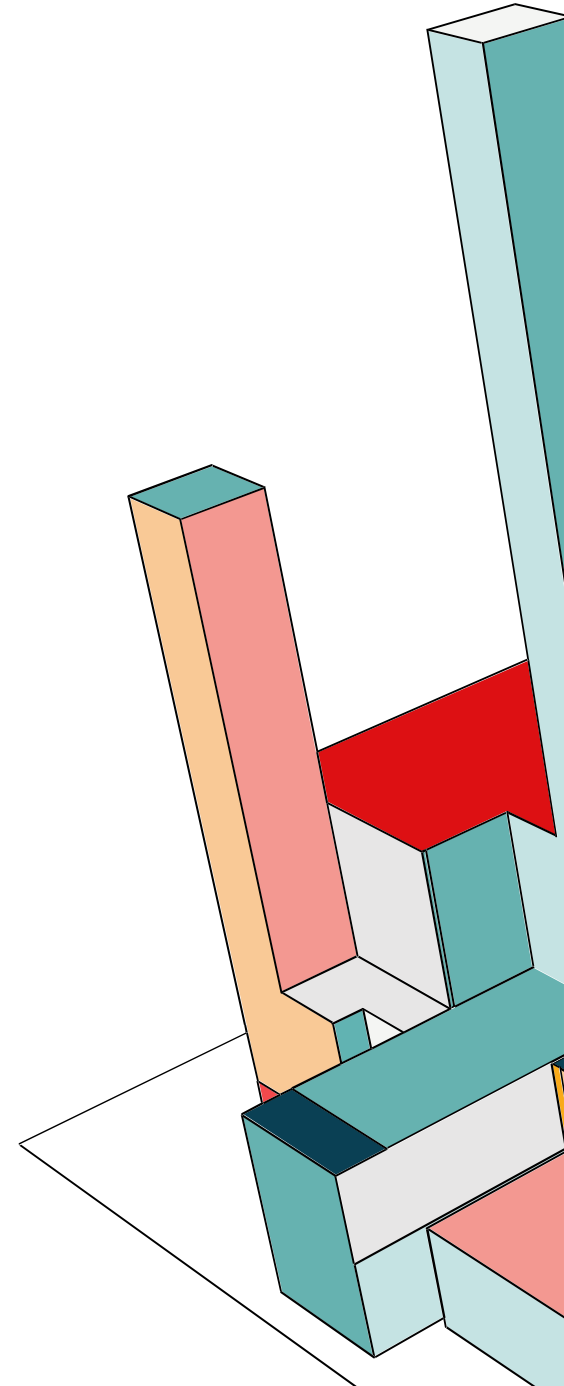

An abstract 3D graphic on the left side of the slide. It features several rectangular blocks of various heights and colors (red, orange, teal, white) arranged in a cluster. Behind them is a large red rectangular wall. The entire scene is set on a light blue base. The number '6' is visible at the bottom of the graphic.

OTHER PERTINENT INITIATIVES

- Implementing Textbook and Parking Pass Reimbursement Programs
- Encourage instructors to utilize Brightspace
- Conduct focus groups on student and faculty experiences with Brightspace
- Research artificial intelligence tools for students
- Support doctoral programs for the university
- Research partnerships with the local Springfield Community

OPPORTUNITIES TO CONTRIBUTE



**AI SURVEY
(FACULTY VERSION)**



**OPEN EDUCATIONAL RESOURCES
SURVEY**

BRIGHTSPACE FOCUS GROUPS

SGA Make Brightspace Better,
Make Your Voice Heard!

- ➔ SHARE YOUR THOUGHTS
- ➔ EARN 2 SERVICE HOURS
- ➔ PLUS FREE SODA!

SIGN UP FOR A SESSION TODAY!
OCT. 20-24 | PLASTER STUDENT UNION



QUESTIONS?

Ruby Knight, Director of Academic Affairs

rrk266s@login.missouristate.edu

Office Hours: MW 2-4pm, PSU 123

